

ASPHALT FLOAT



Easy to use

Patented system. Extremely intuitive to use in the daily job.

Huge cost and time saving

Up to 10 times more quicker than manual labour. In a cleaner, more consistent and safer manner.

Easy to clean. Light.

It has been designed by purpose without a material container. Just place material in front of the float and go forward.

CROSS-SECTION TRENCH FILLING AND ASPHALT FINISHING

High speed and accuracy.

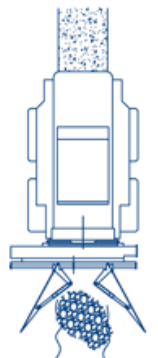

SIDEWALK ASPHALT SURFACING

Hydraulic device to allow operation outside of the prime mover profile. 1700 mm offset.

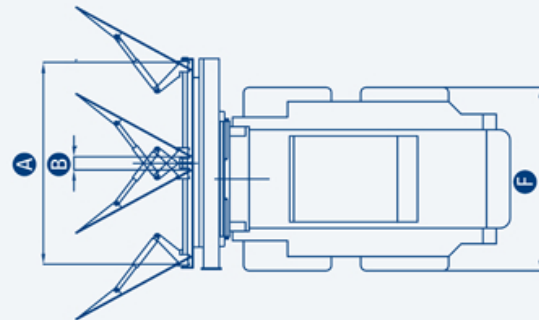
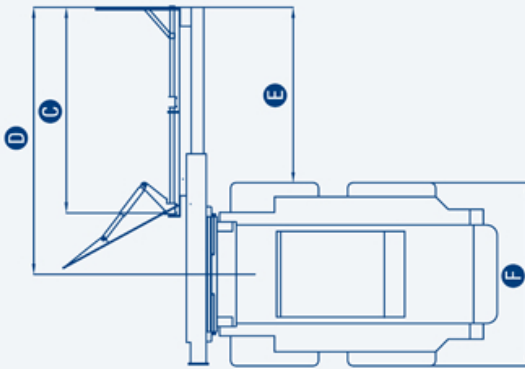
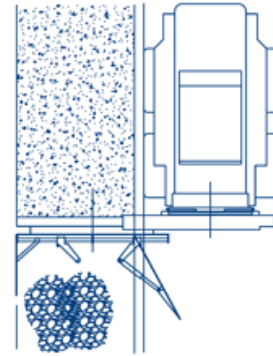

SPECIFICATIONS

	ST 160	ST 200	
A	1500	1900	mm
B	125	125	mm
C	1560	1960	mm
D	1800	2550	mm
E	1025	1675	mm
F	1550	1750	mm
Width adjustment	hydraulic		
Asphalt thickness adjustment (independent on the RH and on the LH sides)	mechanical (screw) or electrical (optional)		
Asphalt thickness	0-100		mm
Side shift	hydraulic		
Transversal inclination	5°		
Average working speed (cross-section trenches)	50-120		m/min
Operating weight (1)	570	620	kg

(1) User is responsible for ensuring that the equipment meets the prime mover's specifications and weight requirements.